

HIKOKI

CIRCULAR SAW C7BUM

Item No.	Code No.	Description	No. Used	Remarks
1	998887	LINER	1	
2	327694	BALL BEARING 6003VVCM (NYLON RETAINER)	1	
3	370591	WASHER	1	
4	370373	RETURN SPRING	1	
5	370356	LOWER GUARD	1	
6	302435	BEARING COVER	1	
7	990430	SEAL LOCK FLAT HD. SCREW M4X10	2	
8	370272	WASHER (A)	1	
9	324668	TCT SAW BLADE 190MM-D30 HOLE-NT18	1	
10A	370354	SAW COVER	1	
11	951039	MACHINE SCREW (W/SP. WASHER) M4X12	3	
12	997247	DUST COLLECTOR	1	
13	935196	MACHINE SCREW (W/WASHERS) M4X12 (BLACK)	1	
14		NAME PLATE (BRAKE)	1	
15	370542	LEVER	1	
16	935196	MACHINE SCREW (W/WASHERS) M4X12 (BLACK)	1	
17	370279	WASHER (B)	1	
18	324662	HEX. SOCKET HD. BOLT M8X15.5	1	
19	930703	BRUSH TERMINAL	2	
20	340946E	STATOR ASS'Y 220V-230V	1	INCLUD. 19
21	370342	FAN GUIDE	1	
22	361037E	ARMATURE 220V-230V	1	
23	962782	HEX. SOCKET SET SCREW M5X6	1	
24	370350	GEAR COVER	1	
25	322096	ADJUSTING SCREW (A)	1	
26	961729	CUSHION	1	
27	949794	FLAT HD. SCREW M6X20 (10 PCS.)	1	
28	370371	SPINDLE AND GEAR SET	1	
29	370353	BEARING HOLDER	1	
30	992013	SEAL LOCK FLAT HD. SCREW M5X14	2	
31	370364	ARM	1	
32	370365	RIVING KNIFE	1	
33	370287	HEX. SOCKET HD. BOLT M8	2	
34	370662	DIAGONAL BOLT M8	1	
35	370363	LOCK LEVER	1	
36	330982	SPRING (A)	1	
37	6001VV	BALL BEARING 6001VV	1	
38	333922	MACHINE SCREW M6X14	1	
39	949455	SPRING WASHER M6 (10 PCS.)	1	
40	949425	WASHER M6 (10 PCS.)	1	
41	323923	LEVER (A)	1	
42	333921	LOCK NUT	1	
43	318452	WASHER (G)	1	
44	324660	KNOB	1	
45	676531	O-RING (P-7)	1	
46	949433	BOLT WASHER M8 (10 PCS.)	1	
47	370825	SLEEVE (A)	1	
48	370268	SLEEVE (B)	1	
49	370278	SEAL LOCK HEX. SOCKET HD. BOLT M4X6	1	
50	320163	STEP PIN D6X13	1	
51	370369	PLATE (B)	1	
52	370377	BOLT (SQUARE) D6	1	
53	319541	SEAL LOCK HEX. SOCKET SET SCREW M5X6	1	

* ALTERNATIVE PARTS

HIKOKI

CIRCULAR SAW C7BUM

Item No.	Code No.	Description	No. Used	Remarks
54	305755	HEX. SOCKET HD. BOLT (W/FLANGE) M5X12	2	
55	370370	BEVEL PLATE (C)	1	
56A	377291	NYLON NUT M5	1	
57	678653	MACHINE SCREW (W/WASHERS) M5X14 (BLACK)	7	
58	370347	BEVEL PLATE (A)	1	
59	301806	WING BOLT M6X15	1	
60	947859	LOCK SPRING	1	
61A	379529	NYLOCK SET SCREW M6	2	
62	370358	BASE	1	
63	370348	BEVEL PLATE (B)	1	
64	949425	WASHER M6 (10 PCS.)	1	
65	302459	WING BOLT M6X17	1	
66	370361	LINK	1	
67	997841	MACHINE SCREW (W/WASHERS) M5X50 (BLACK)	3	
68	301653	TAPPING SCREW (W/FLANGE) D4X20 (BLACK)	6	
69	938477	HEX. SOCKET SET SCREW M5X8	2	
70	960685	BRUSH HOLDER	2	
71	999056	CARBON BRUSH (1 PAIR)	2	
72	945161	BRUSH CAP	2	
73	370269	CORD HOLDER	1	
74	953327	CORD ARMOR D8.8	1	
75	500390Z	CORD	1	(CORD ARMOR D8.8)
76		NAME PLATE	1	
77A	370820	HOUSING ASS'Y	1	INCLUD. 69, 70
78	331006	RUBBER BUSHING	1	
79	322089	BEARING BUSHING	1	
80	333945	BALL BEARING 608VV	1	
81	331707	FASTON	1	
82	937631	CORD CLIP	1	
83	984750	TAPPING SCREW (W/FLANGE) D4X16	2	
84	959141	CONNECTOR 50092 (10 PCS.)	2	
85	931701	BEARING LOCK	1	
86	334474	SWITCH	1	
87	370661	INTERNAL WIRE	1	
88	930039	NOISE SUPPRESSOR	1	
89	370341	HANDLE COVER	1	
90	371213	PLATE (C)	1	
91	935196	MACHINE SCREW (W/WASHERS) M4X12 (BLACK)	1	
		STANDARD ACCESSORIES		
501	370587	GUIDE	1	
502	872422	HEX. BAR WRENCH 6MM	1	
503	370264	LEVER	1	
504	337528	CASE ASS'Y (STACKABLE 4)	1	INCLUD. 505-507
505	336472	LATCH	4	
506	336473	HANDLE	1	
507	336474	HINGE	2	
508	370588	BOTTOM CUSHION	1	

* ALTERNATIVE PARTS

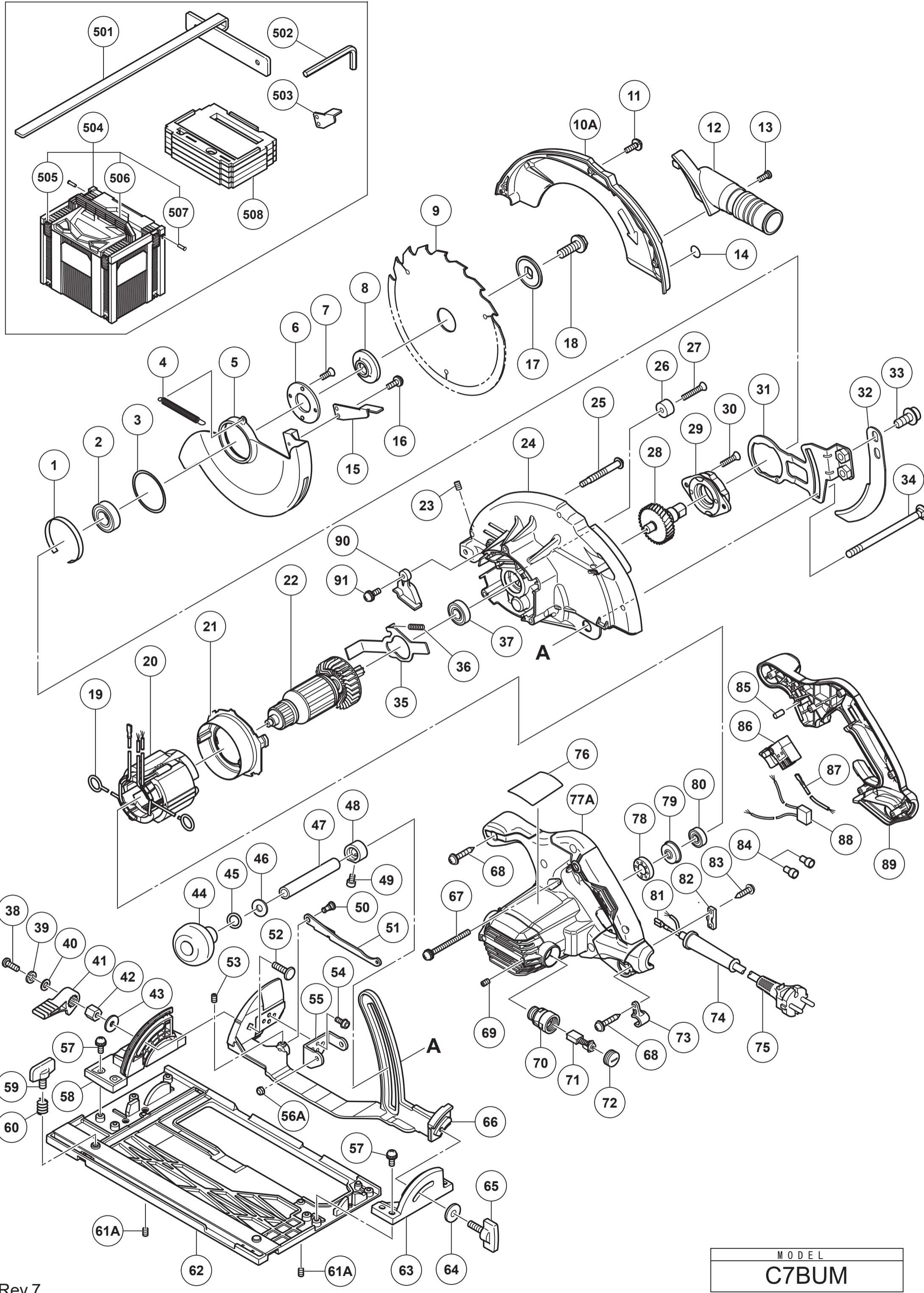

MODEL
C7BUM