

# HIKOKI

## CORDLESS CIRCULAR SAW C3607DB

Item No.	Code No.	Description	No. Used	Remarks
1	305490	TAPPING SCREW (W/FLANGE) D4X30 (BLACK)	2	
2	380747	HOOK ASS'Y	1	
3		NAME PLATE	1	
*4A	382970	HANDLE SET	1	
*5B	341217	STATOR SENSOR PCB ASS'Y	1	INCLUD.7,14 SINCE 2.2025
6	338899	TRIGGER	1	
7	371907	SWITCH	1	
8	379531	KNOB	1	
9	301631	SPRING (F)	1	
10	301653	TAPPING SCREW (W/FLANGE) D4X20 (BLACK)	7	
11	307811	TAPPING SCREW (W/FLANGE) D4X16 (BLACK)	5	
*12	380082	BATTERY BSL 36A18X (EUROPE,AUS,NZL)	2	INCLUD.503
13	935196	MACHINE SCREW (W/WASHERS) M4X12 (BLACK)	3	
14	380737	LED	1	
15	305691	MACHINE SCREW (W/WASHERS) M4X14 (BLACK)	3	
*16	380727	GEAR COVER	1	
17	373814	FLOW GUIDE (A)	1	
18	337080	CUSHION	1	
19	377945	FLAT HD. SCREW M6X20	1	
20	334141	MACHINE SCREW (W/WASHERS) M4X35 (BLACK)	4	
21	338919	FLOW GUIDE	1	
*22	380728	HOUSING SET	1	
23	380748	CUSHION	1	
24	372734	WASHER (A)	1	
25	338928	RUBBER BUSHING	1	
26	361231	ROTOR ASS'Y	1	INCLUD.27,28
27	606ZZM	BALL BEARING 606VV	1	
28	6000VV	BALL BEARING 6000VVCMP2L	1	
29	338918	LOCK LEVER	1	
30	334225	SPRING	1	
31	372746	LOCK NUT	1	
32	670514	RETAINING RING (E-TYPE) FOR D10 SHAFT	1	
33	372745	LEVER	1	
34	320975	WASHER	1	
35	380726	SPINDLE GEAR	1	
36	373810	BEARING HOLDER	1	
37	992013	SEAL LOCK FLAT HD. SCREW M5X14	2	
38	6003VV	BALL BEARING 6003VVCMP2L	1	
39	373811	BUSH	1	
40	370591	WASHER	1	
41	373011	RETURN SPRING	1	
42	373812	LOWER GUARD	1	
43	302435	BEARING COVER	1	
44	990430	SEAL LOCK FLAT HD. SCREW M4X10	2	
*45	324597	WASHER (A)	1	FOR EUROPE,GBR
*46	324668	TCT SAW BLADE 190MM-D30 HOLE-NT18	1	FOR EUROPE,GBR
*47	377434	WASHER (B)	1	FOR EUROPE,GBR,TPE
48	338917	HEX. FLANGE BOLT	1	
49	377952	LEVER (A)	1	
51	942827	RETAINING RING (E-TYPE) FOR D8 SHAFT	1	
52	333659	CLAMP LEVER	1	
53	333660	SPECIAL NUT M6	1	
54	320975	WASHER	1	

\* ALTERNATIVE PARTS

# HIKOKI

## CORDLESS CIRCULAR SAW C3607DB

Item No.	Code No.	Description	No. Used	Remarks
*55	319541	SEAL LOCK HEX. SOCKET SET SCREW M5X6	2	EXCEPT FOR USA,CAN
59	308109	SLOTTED HD. SET SCREW (SEAL LOCK) M6X8	1	
61	380731	BEVEL PLATE	1	
62	942808	BOLT (SQUARE) M6X20	1	
*63	372749	STEP PIN	2	EXCEPT FOR USA,CAN
65	377946	ROLL PIN D6X50	1	
66	372747	BOLT (SQUARE) M6	1	
*67	324562	KNOB BOLT	3	FOR EUROPE,GBR
*68	319541	SEAL LOCK HEX. SOCKET SET SCREW M5X6	2	FOR EUROPE,GBR
*69	380746	GUIDE RAIL PLATE	1	FOR EUROPE,GBR
*70	307898	WING BOLT M6X18	1	FOR EUROPE,GBR
*71	324876	SPRING	1	FOR EUROPE,GBR
*72	380743	GUIDE RAIL ADAPTER	1	FOR EUROPE,GBR
*73	380744	GUIDE BAR (A)	1	FOR EUROPE,GBR
*74	380745	GUIDE BAR (B)	1	FOR EUROPE,GBR
*75	380739	BASE ASS'Y	1	INCLUD.51-55,59,61-63,76-80 FOR EUROPE, GBR
*76	380736	MACHINE SCREW (W/SP. WASHER) M3X6	1	FOR EUROPE,GBR
*77	380735	SPRING PLATE	1	FOR EUROPE,GBR
*78	339604	SEAL LOCK HEX. SOCKET SET SCREW M5X12	1	EXCEPT FOR USA,CAN
*79	380733	LINK	1	EXCEPT FOR USA,CAN
*80	380730	BASE	1	EXCEPT FOR USA,CAN
*81	382969	HANDLE CONTROLLER SET	1	INCLUD.4A,5B TILL 1.2025
		STANDARD ACCESSORIES		
501		CHARGER (MODEL UC 18YSL3)	1	
502	944459	HEX. BAR WRENCH 5MM	1	
503	329897	BATTERY COVER	2	
*504	377954	DUST COLLECTOR (A)	1	FOR EUROPE,GBR
*505	935196	MACHINE SCREW (W/WASHERS) M4X12 (BLACK)	1	FOR EUROPE,GBR
*510	380751	INNER TRAY	1	FOR EUROPE,GBR,AUS,NZL,MAL,TPE
*511	337528	CASE ASS'Y (STACKABLE 4)	1	INCLUD.512-514 FOR EUROPE,GBR,AUS,NZL, MAL,TPE
*512	336472	LATCH	4	FOR EUROPE,GBR,AUS,NZL,MAL,TPE
*513	336473	HANDLE	1	FOR EUROPE,GBR,AUS,NZL,MAL,TPE
*514	336474	HINGE	2	FOR EUROPE,GBR,AUS,NZL,MAL,TPE
		OPTIONAL ACCESSORIES		
*603	380742	GUIDE RAIL ADAPTER SET	1	INCLUD.67-74,76,77,604 EXCEPT FOR USA, CAN
*604	990666	HEX. BAR WRENCH 2.5MM	1	EXCEPT FOR USA,CAN
*605	302691	GUIDE	1	FOR EUROPE,GBR,USA,CAN
*606	301806	WING BOLT M6X15	1	FOR EUROPE,GBR,USA,CAN
*607	947859	LOCK SPRING	1	FOR EUROPE,GBR,USA,CAN

\* ALTERNATIVE PARTS

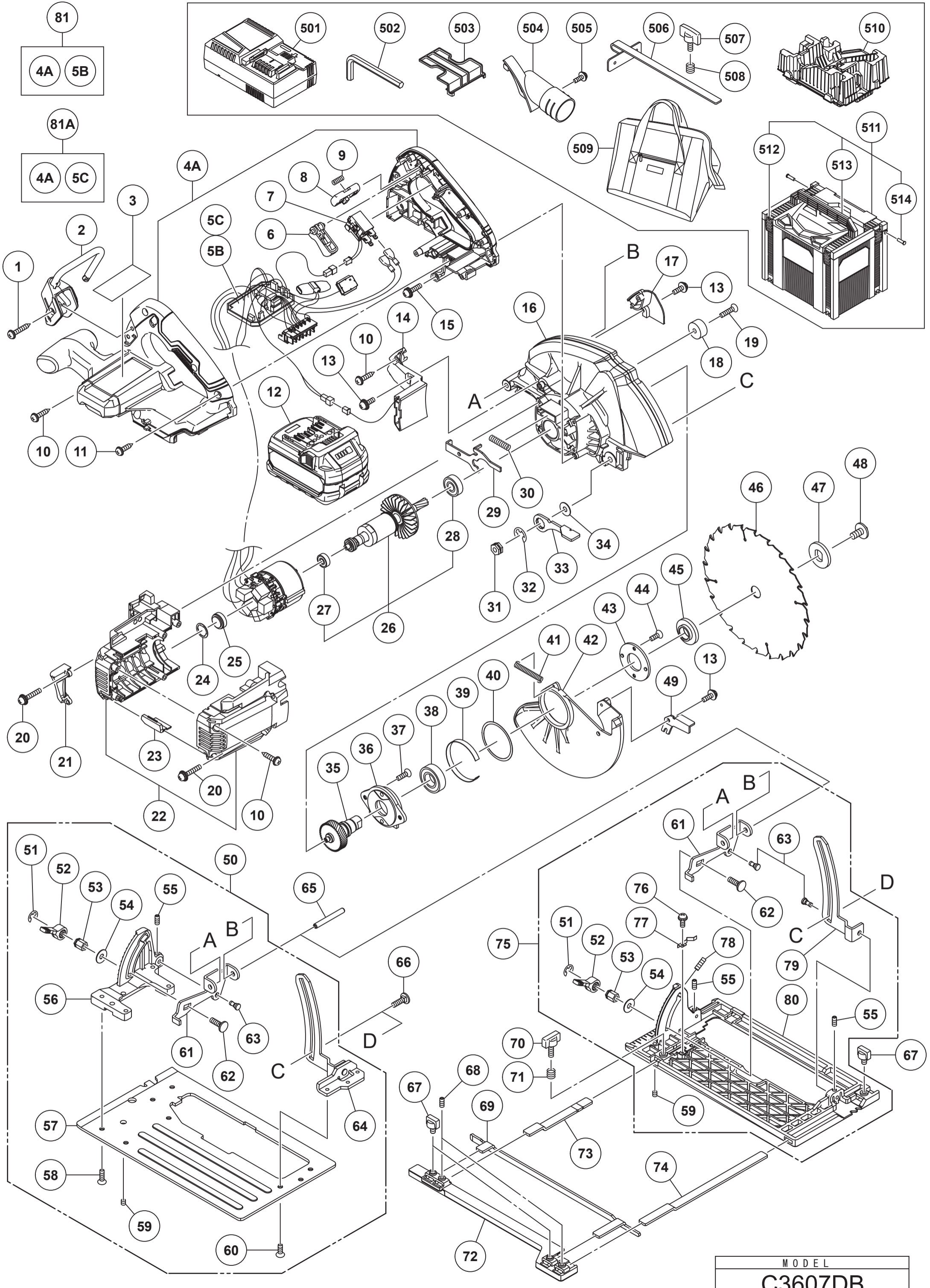

MODEL  
C3607DB